



50L ELECTRIC

SMART THINGS COME IN SMALL PACKAGES

Designed to be everything required for tight installations.

We solved access problems by providing dual handed fittings and relocating all the service outlets to the front.



160L SQUAT

A BIG TANK MADE FOR SHORT SPACES

The AquaMAX commitment to innovation continues with the 160 Litre Electric Squat. An Electric Water Heater that brings larger capacity to awkward indoor spaces. With dual inlets and outlets, the 160 Litre Electric Squat brings reliable delivery in a smarter package.



250L-400L ELECTRICS

BIG DELIVERY, LOWER RUNNING COSTS

The AquaMAX large Electric water heater range provides an option to take advantage of lower cost off-peak tariffs.² Built with dual inlets and outlets (like the rest of the range), the 250-400 Litre Electric range is available in single or twin element models.

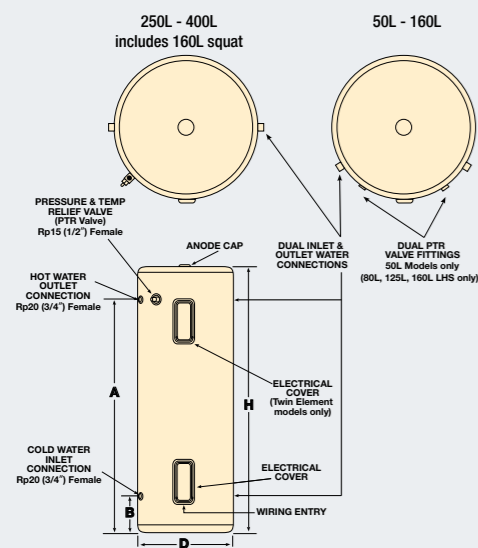

Water Heater Dimensions (mm)

	H	A	B	D
991050	695	539	142	400
981080	875	669	194	460
981125	1250	1047	195	480
971160	1610	1436	104	480
9W1160	965	755	113	640
991250/992250	1395	1190	73	640
991315/992315	1640	1430	113	640
991400/992400	1840	1600	121	690

Aquamax Australia Pty Ltd 463-467 Warrigal Road Moorabbin Vic 3189
 Toll Free: 131 031 Sales Ph: 132 552 Sales Fax: 1300 554 821
 Email: sales@aquamax.com.au For more information visit www.aquamax.com.au
 A.B.N. 37 138 189 689



“AquaMAX Electric Water Heaters... giving you more in hot water”

Stay in hot water with AquaMAX.

Award winning AquaMAX high efficiency Electric Water Heaters provide your family with all the hot water they need.

AquaMAX Mains Pressure Electric Water Heaters are built using the latest technology and with a cylinder warranty¹ up to 10 years. They are available in sizes to suit most applications.

AquaMAX Electric Water Heaters are made for Aussie conditions, to suit both metro and regional areas.

FAMILIES BIG AND SMALL

AquaMAX Electric Mains Pressure Water Heaters provide families big and small with reliable hot water. AquaMAX inhouse factory testing ensures every new system we build meets our exacting standards whether it's installed indoors or outdoors. You can also take advantage of lower cost off-peak tariffs for added savings on your energy bills.²

HOW DO WE MAKE THEM ACHIEVE OUR STANDARD?

After our cylinders have been fully welded, we apply a high quality enamel coating to create our enamel lining. Combined with a sacrificial anode and protected by a steel casing with rounded edges, every AquaMAX Electric Water Heater is backed by a 10 or 7 year cylinder warranty.¹



Electric Specifications

	400 Litre			315 Litre				250 Litre				160 Litre Squat		160 Litre			125 Litre			80 Litre	50 Litre
	991400G7	991400C8	992400C8	991315G7	991315G8	992315G7	992315C8	991250G7	991250G7/BL	991250C8	992250G7	9W1160C4	9W1160C5	971160C4	971160C5	971160C7	981125C4	981125C4/BL	981125C7	981080C7	991050C7
Number of People Served	5-9			4-6				3-5				2-4		2-4			2-3			1-2	1
- Continuous/Time of Use Tariff	5-9			4-6				3-5				2-4		2-4			2-3			1-2	1
- Off peak/night rate	4-6			2-4				1-3				-		-			-			-	-
Hot Water Delivery Litres	400			315				250				160		160			125			80	50
Storage Capacity Litres	410			325				270				175		165			135			90	53
Boost Capacity (Twin Element) Litres	-			90				-				50		-			-			-	-
Weight packaged (approx) kg	120			97				82				58		59			45			32	26
Maximum Loading Watts	3600	4800	4800	3600	4800	3600	4800	3600	3600	4800	3600	1800	2400	1800	2400	3600	1800	1800	3600	3600	3600
Heating Element Upper Watts	-			4800				-				3600		-			-			-	-
Heating Element Lower Watts	3600	4800	4800	3600	4800	3600	4800	3600	3600	4800	3600	1800	2400	1800	2400	3600	1800	1800	3600	3600	3600

Specifications

	991400	991315	991250	9W1160	971160	981125	981080	991050
Voltage (single phase)	240Vac	240Vac	240Vac	240Vac	240Vac	240Vac	240Vac	240Vac
Maximum Supply Pressure								
with expansion control valve (ECV)	680 kPa	680 kPa	960 kPa	680 kPa	680 kPa	680 kPa	680 kPa	680 kPa
without expansion control valve (ECV)	800 kPa	800 kPa	1120 kPa	800 kPa	800 kPa	800 kPa	800 kPa	800 kPa
Pressure & Temp Relief Valve	1000 kPa	1000 kPa	1400 kPa	1000 kPa	1000 kPa	1000 kPa	1000 kPa	1000 kPa
ECV setting	850 kPa	850 kPa	1200 kPa	850 kPa	850 kPa	850 kPa	850 kPa	850 kPa
Thermostat setting (Maximum)	70°C	70°C	70°C	70°C	70°C	70°C	70°C	75°C
Hot & Cold Water connection	Rp 3/4" Female	Rp 3/4" Female	Rp 3/4" Female	Rp 3/4" Female	Rp 3/4" Female	Rp 3/4" Female	Rp 3/4" Female	Rp 3/4" Female
Warranty (Cylinder) ¹	10 years*	10 years*	10 years*	10 years*	10 years*	10 years*	10 years*	7 years [†]
Warranty (Parts & Labour) ¹	1 year	1 year	1 year	1 year	1 year	1 year	1 year	1 year
Protection rating	IP24	IP24	IP24	IP24	IP24	IP24	IP24	IP24

Due to constant product improvements, the specifications are subject to change without notice.

1. Conditions apply. Full warranty details available on request from AquaMax, call Toll Free 131 031, see the warranty set out in the Owner's Guide and Installation Instructions or view at www.aquamax.com.au

* 10 year cylinder warranty applies to – 991400, 992400, 991315, 992315, 991250, 992250 models manufactured on or after 20/11/2017, 971160 model manufactured on or after 10/4/2018, 981125, and 981080 models manufactured on or after 01/3/2018.

† 7 year cylinder warranty applies to – 991050 model manufactured on or after 01/3/2018.

2. Please refer to your energy provider.

AQUAMAX GAS WATER HEATER SPECIFICATIONS

5 Star Gas
STAINLESS STEEL



SPECIFICATIONS

	G390 SS (WITH MIXING VALVE)	G340 SS	G270 SS
Number of people Served	3-6	2-5	2-4
Model	G390SS	G340SS	G270SS
Gas type	Natural	Natural	Natural
Cylinder Capacity	155 Litres	155 Litres	130 Litres
Nominal gas consumption	40 MJ/Hr	40 MJ/Hr	33 MJ/Hr
AGA Star Rating Index	5 Stars	5 Stars	5 Stars
Recovery rate at 45°C rise	185 Litres/Hr ²	185 Litres/Hr ²	145 Litres/Hr ²
Installation type	External only	External only	External only
Pressure & Temperature Relief Valve setting	1400 kPa/99°C	1400 kPa/99°C	1400 kPa/99°C
Max. water supply pressure w/o ECV	1120 kPa	1120 kPa	1120 kPa
Cylinder material	stainless steel	stainless steel	stainless steel
Water inlet connection	Rp 3/4" Female	Rp 3/4" Female	Rp 3/4" Female
Water outlet connection	Rp 3/4" Female	Rp 1/2" Female	Rp 1/2" Female
Gas connection	1/2" flared compression	1/2" flared compression	1/2" flared compression
Warranty (Cylinder) ¹	12 years	12 years	12 years
WaterMark Licence No.	WMKA00200	WMKA00200	WMKA00200
Overall height	1625mm	1635mm	1410mm
Width (approx.)	520mm	520mm	475mm
Depth (approx.)	610mm	610mm	565mm
AGA Approval No.	AGA6114G	AGA6114G	AGA7477G
Weight (packaged)	65 kg	64 kg	49 kg

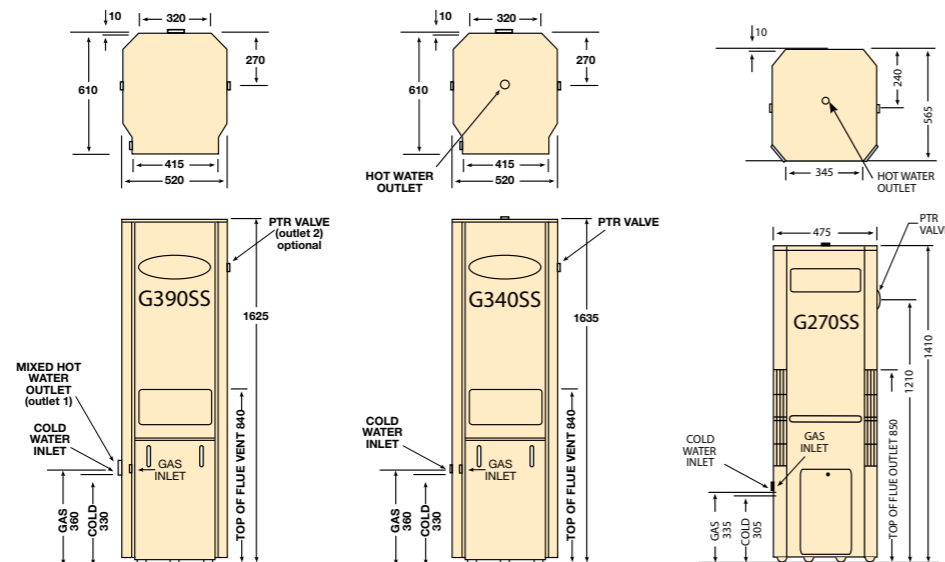

¹ Warranty: 12 years on cylinder, 3 years parts and labour on cylinder, 1 year parts and labour on all other components, when installed in a domestic dwelling. For all other installations, warranty period is one year parts and labour on all components. Warranty applies to product manufactured on or after 09/04/2018. Conditions apply, see the AquaMax warranty set out in the Owner's Guide and Installation Instructions or view at www.aquamax.com.au

² Based on cold water temperature of 15°C

³ Note: AquaMax Stainless Steel Water Heaters are not recommended for installation in some areas. Refer to the AquaMax website for details of areas not recommended and for which product is not covered by warranty.

Aquamax Australia Pty Ltd 463-467 Warrigal Road Moorabbin Vic 3189
 Toll Free: 131 031 Sales Ph: 132 552 Sales Fax: 1300 554 821
 Email: sales@aquamax.com.au For more information visit www.aquamax.com.au
 A.B.N. 37 138 189 689

® Registered Trademark of AquaMAX Australia Pty Ltd.
 Materials, product data and specifications subject to change without notice

"Giving you more in
Hot Water"

12
YEAR
CYLINDER
WARRANTY



AUSTRALIAN MADE STAINLESS STEEL GAS WATER HEATERS

July 2018
 Part No. AQ0905033-G

STAR PERFORMERS FROM AQUAMAX

AquaMax gas water heaters offer you more than just 5 Star energy efficiency.

With Stainless Steel cylinders across the range they are the preferred choice for homeowners and plumbers alike.

Providing hot water recovery of up to 185 litres per hour, there is an AquaMax model to suit even the largest household.



G390 SS

G340 SS

G270 SS



OUTSTANDING FEATURES

5 STAR ENERGY EFFICIENCY
to help you save on energy bills

STAINLESS STEEL CYLINDERS
can resist corrosion for longer than conventional enamelled steel cylinders³

12 YEAR CYLINDER WARRANTY¹

HOT WATER RECOVERY FROM 145 TO 185 LITRES AN HOUR²
to have you back in hot water faster, and also handy in times of heavy hot water demand

SIGNIFICANTLY LIGHTER
than traditional enamelled steel cylinder water heaters, which assists in easier installation

NO ANODE REQUIRED
so reducing lifetime service costs

INBUILT MIXING VALVE
on AquaMax G390SS so you can adjust the hot water delivery to as much as 205L in an hour (depending on temperature chosen)*

*NOTE: the inbuilt mixing valve is not an approved temperature limiting device. Applications requiring tempering to comply with AS3498 must have a tempering valve installed in accordance with AS3500.4



“Giving you more in
Hot Water”