

PVC NON-PRESSURE
DWV SEWER PIPE & FITTINGS
AS/NZS 1260
RUBBER RING JOINT

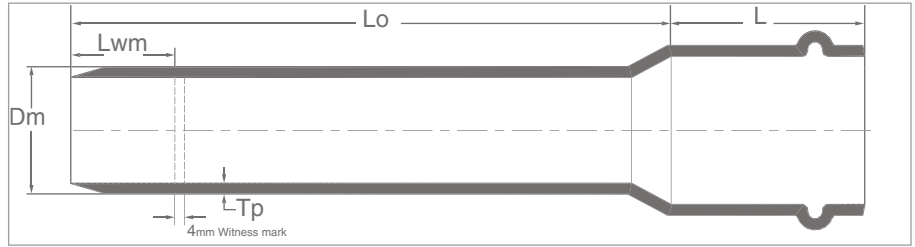

DWV Sewer Pipe RRJ

DWV - Rubber Ring Joint



DWV (SEWER) PIPE

VINIDEX CODE	NOMINAL DIAMETER DN (MM)	REVISED CLASS	LENGTH	MEAN OD	MIN WALL THICKNESS	SOCKET DEPTH	SPIGOT LENGTH	CRATE QTY	WEIGHT (kg)
			Lo (m)	Dm (mm)	Tp (mm)	L (mm)	Lwm (mm)		
19530	100	SN 10	6	110	3	120	91	26	11.45
19540	150	SN 4	6	160	4.2	135	119	26	18.20
19610	150	SN 8	3	160	5.2	135	119	28	9.30
19680	225	SN 8	3	250	8.2	160	153	12	29.30
19730	300	SN 8	3	315	10.4	180	176	6	45.60

NOTE: SN = Stiffness, a measure of ability for the pipe to withstand lateral deflection, "Squashing".

SN4 = 4000 N|m|m

SN6 = 6000 N|m|m

SN8 = 8000 N|m|m

SN10 = 10000 N|m|m

DWV Sewer Fittings RRJ

DWV - Rubber Ring Joint

45° SEWER BENDS F & F

VINIDEX CODE	NOMINAL SIZE (mm)	L (mm)	L ¹ (mm)	L ² (mm)	PACK QTY	W (kg)
50030	100	78	175	-	1	0.01
50320	150	78	287	287	1	1.31

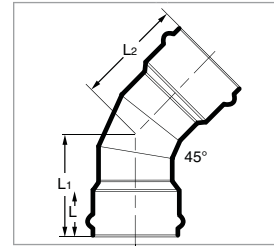

88° SEWER BENDS F & F

VINIDEX CODE	NOMINAL SIZE (mm)	L (mm)	L ¹ (mm)	L ² (mm)	PACK QTY	W (kg)
50330	150	94	438	350	1	1.77

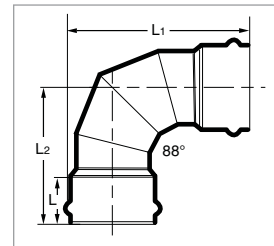

90° SEWER BENDS F & F

VINIDEX CODE	NOMINAL SIZE (mm)	L (mm)	L ¹ (mm)	L ² (mm)	PACK QTY	W (kg)
50050	100	78	230	120	1	0.10

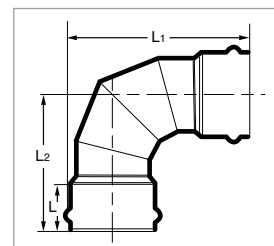

DWV - Rubber Ring Joint

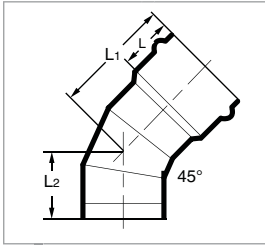

45° SEWER BENDS M & F

VINIDEX CODE	NOMINAL SIZE (mm)	L (mm)	L ¹ (mm)	L ² (mm)	PACK QTY	W (kg)
50080	100	97	175	78	1	0.01
50360	150	99	268.5	235	1	1.20

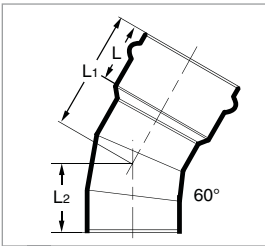

60° SEWER BENDS M & F

VINIDEX CODE	NOMINAL SIZE (mm)	L (mm)	L ¹ (mm)	L ² (mm)	PACK QTY	W (kg)
50090	100	98	225	79	1	0.01

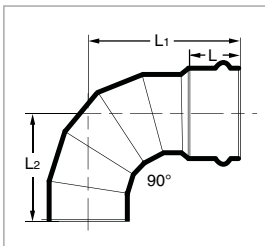

90° SEWER BENDS M & F

VINIDEX CODE	NOMINAL SIZE (mm)	L (mm)	L ¹ (mm)	L ² (mm)	PACK QTY	W (kg)
50370	150	99	155	259	1	1.60

DWV Sewer Fittings RRJ

DWV - Rubber Ring Joint

45° SEWER JUNCTIONS F & F

VINIDEX CODE	NOMINAL SIZE (mm)	L (mm)	L ¹ (mm)	L ² (mm)	PACK QTY	W (kg)
50100	100	78	465	290	1	0.10
50400	150	94	545	410	1	2.00
50380	150 x 100	94	545	410	1	2.00
50390	SWJ Branch	94	545	410	1	2.00
51060	225 x 100	122	840	520	1	1.00
51070	226 x 100	122	840	520	1	4.00
51080	225 x 150	122	840	520	1	0.10
51090	225 x 150	122	840	520	1	11.60
51710	300 x 100	147	1000	660	1	13.40
51720	300 x 100	147	1000	660	1	12.40
51730	300 x 150	147	1000	660	1	0.10

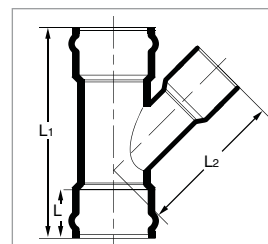

SWJ Branch

90° SEWER JUNCTIONS F & F

VINIDEX CODE	NOMINAL SIZE (mm)	L (mm)	L ¹ (mm)	L ² (mm)	PACK QTY	W (kg)
50470	150	94	360	540	1	3.90

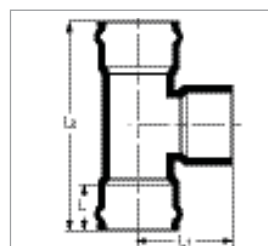

45° SEWER JUNCTIONS M & F

VINIDEX CODE	NOMINAL SIZE (mm)	L ¹ (mm)	L ² (mm)	PACK QTY	W (kg)
50430	150	545	410	1	2.60
50410	150 x 100	545	410	1	2.00
51100	225 x 100	840	520	1	0.10
51120	225 x 150	840	520	1	0.10
51760	300 x 100	1000	660	1	0.10

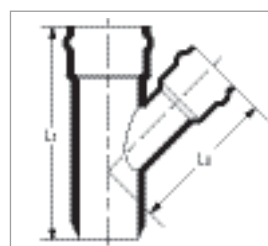

DWV Sewer Fittings RRJ

DWV - Rubber Ring Joint

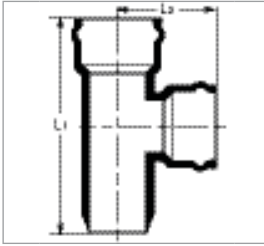

90° SEWER JUNCTIONS M & F

VINIDEX CODE	NOMINAL SIZE (mm)	L ¹ (mm)	L ² (mm)	PACK QTY	W (kg)
50500	150	540	360	1	3.80

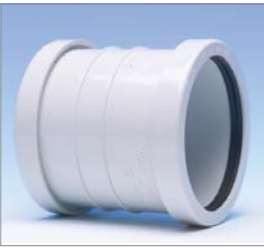

SEWER SLIP COUPLINGS

VINIDEX CODE	NOMINAL SIZE (mm)	L ¹ (mm)	PACK QTY	W (kg)
50220	100	140	5	1.30
50520	150	210	1	1.10
51430	225	325	1	0.10
52150	300	460	1	6.60

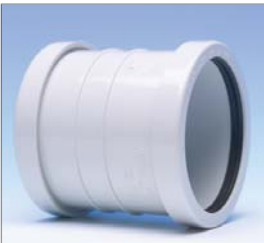
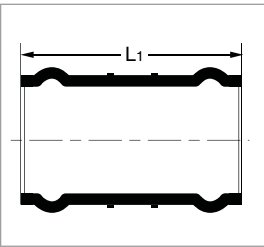

SEWER STRAIGHT COUPLINGS

VINIDEX CODE	NOMINAL SIZE (mm)	L (mm)	PACK QTY	W (kg)
50170	100	145	1	0.01

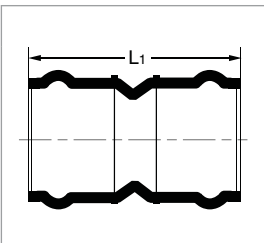

DWV Sewer Fittings RRJ

DWV - Rubber Ring Joint

SEWER VERTICAL DROP

VINIDEX CODE	NOMINAL SIZE (mm)	C (mm)	L ¹ (mm)	L ² (mm)	PACK QTY	W (kg)
47520	100	78	195	150	1	0.10
47590	150	94	241	150	1	0.10

QLD only.

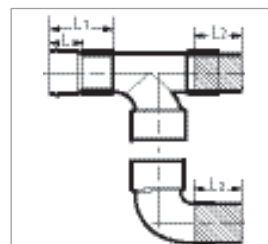

THREADED ACCESS CAPS

VINIDEX CODE	NOMINAL SIZE (mm)	L ¹ (mm)	L ² (mm)	PACK QTY	W (kg)
46430	100	125	29	10	0.20
47270	150	175	30	10	0.30

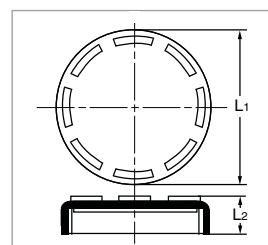

DWV (SEWER) PIPE [SHORT PIPES - SANDED]

VINIDEX CODE	NOMINAL DIAMETER (mm)	REVISED CLASS	TYPE	L (mm)	L ² (mm)	PACK QTY	W (kg)
50835	100	SN 8	Socket	400	150	1	0.10
50865	100	SN 8	Spigot	350	150	1	-
50942	150	SN 8	Socket	420	150	1	0.10
50949	150	SN 8	Spigot	435	300	1	0.10
51524	225	SN 8	Socket	440	225	1	0.10
51544	225	SN 8	Spigot	440	210	1	4.68
52244	300	SN 8	Socket	440	225	1	-

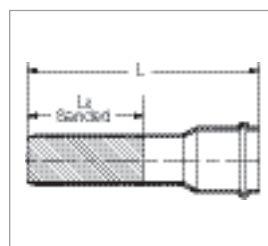

DWV Sewer Fittings RRJ

DWV - Rubber Ring Joint



SEWER LEVEL INVERT TAPER

VINIDEX CODE	NOMINAL SIZE (mm)	L ¹ (mm)	L ² (mm)	PACK QTY	W (kg)
50210	150 x 100	209	97	1	0.10

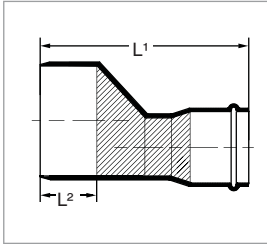

SANDED MANHOLE COUPLINGS

VINIDEX CODE	NOMINAL SIZE (mm)	L ¹ (mm)	L ² (mm)	PACK QTY	W (kg)
50830	100	300	122	1	0.10
50945	150	365	140	1	0.10
51530	225	460	160	1	0.10
52250	300	530	187	1	7.20

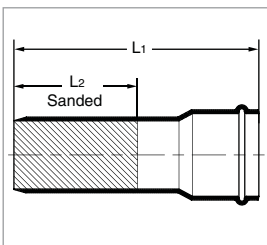

DWV Sewer Fittings RRJ

DWV - Rubber Ring Joint

SANDED COMBINATION M/H COUPLINGS - SCJ TO RRJ

VINIDEX CODE	NOMINAL SIZE (mm)	L (mm)	L ¹ (mm)	PACK QTY	W (kg)
50852	100	405	500	1	0.10
50947	150	390	500	1	0.10
51535	225	360	500	1	0.10

SEWER ADAPTORS

VINIDEX CODE	NOMINAL SIZE (mm)	L ¹ (mm)	PACK QTY	W (kg)
46630	100	112	1	0.40
47350	150	150.5	5	0.80

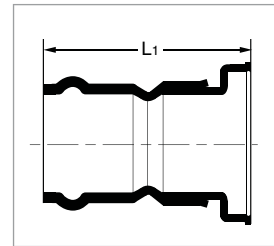

DWV Sewer Fittings RRJ

DWV - Rubber Ring Joint

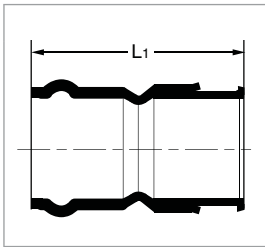
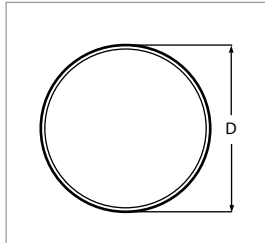
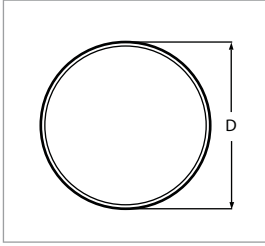

SEWER RUBBER RINGS - NATURAL RUBBER 2 WHITE DOTS

VINIDEX CODE	NOMINAL SIZE (mm)	D (mm)	PACK QTY	W (kg)
82800	150	150	1	0.10
82820	225	225	1	0.10
82830	300	300	1	0.12

SEWER RUBBER RINGS - SBR 2 BLUE DOTS

VINIDEX CODE	NOMINAL SIZE (mm)	D (mm)	PACK QTY	W (kg)
82870	100	100	1	0.10
82880	150	150	1	0.13
82890	225	225	1	0.15
82900	300	300	1	0.18

SEWER VC - PVC BUSH

VINIDEX CODE	NOMINAL SIZE (mm)	L' (mm)	PACK QTY	W (kg)
46640	100	54.5	10	0.30
47370	150	79.6	1	0.60
47470	225	-	1	1.50

Limitation of Liability

This product catalogue has been compiled by Vinidex Pty Limited ("the Company") to promote better understanding of the technical aspects of the Company's products to assist users in obtaining from them the best possible performance. The product catalogue is supplied subject to acknowledgement of the following conditions: 1 The product catalogue is protected by copyright and may not be copied or reproduced in any form or by any means in whole or in part without prior consent in writing by the Company. 2 Product specifications, usage data and advisory information may change from time to time with advances in research and field experience. The Company reserves the right to make such changes at any time without further notice.

3 Correct usage of the Company's products involves engineering and technical judgements, which can not be properly made without full knowledge of all the conditions pertaining to each specific installation. The Company expressly disclaims all and any liability to any person whether supplied with this publication or not in respect of anything and all of the consequences of anything done or omitted to be done by any such person in reliance whether whole or part of the contents of this publication. 4 No offer to trade, nor any conditions of trading, are expressed or implied by the issue of content of this product catalogue. Nothing herein shall override the Company's Condition of Sale, which may be obtained from the Registered Office or any Sales Office of the Company. 5 This product catalogue is and shall remain the property of the Company, and shall be surrendered on demand to the Company. 6 Information supplied in this product catalogue does not override a job specification, where such conflict arises; consult the authority supervising the job. © Copyright Vinidex Pty Limited.

Disclaimer

Advisory information concerning usage of Vinidex products is published to assist users to obtain best performance, and represents the best information available at the time of publishing. No warranty is expressed or implied, nor will any liability be accepted by Vinidex for any consequences resulting directly or indirectly from the use of such information. Product data and advisory information are subject to change at any time without notice.

VIN296 20110926