

PVC NON-PRESSURE

DWV SEWER PIPE & FITTINGS
AS/NZS 1260
SOLVENT CEMENT JOINT



Limitation of Liability

This product catalogue has been compiled by Vinidex Pty Limited ("the Company") to promote better understanding of the technical aspects of the Company's products to assist users in obtaining from them the best possible performance. The product catalogue is supplied subject to acknowledgement of the following conditions: 1 The product catalogue is protected by copyright and may not be copied or reproduced in any form or by any means in whole or in part without prior consent in writing by the Company. 2 Product specifications, usage data and advisory information may change from time to time with advances in research and field experience. The Company reserves the right to make such changes at any time without further notice.

3 Correct usage of the Company's products involves engineering and technical judgements, which can not be properly made without full knowledge of all the conditions pertaining to each specific installation. The Company expressly disclaims all and any liability to any person whether supplied with this publication or not in respect of anything and all of the consequences of anything done or omitted to be done by any such person in reliance whether whole or part of the contents of this publication. 4 No offer to trade, nor any conditions of trading, are expressed or implied by the issue of content of this product catalogue. Nothing herein shall override the Company's Condition of Sale, which may be obtained from the Registered Office or any Sales Office of the Company. 5 This product catalogue is and shall remain the property of the Company, and shall be surrendered on demand to the Company. 6 Information supplied in this product catalogue does not override a job specification, where such conflict arises; consult the authority supervising the job. © Copyright Vinidex Pty Limited.

Disclaimer

Advisory information concerning usage of Vinidex products is published to assist users to obtain best performance, and represents the best information available at the time of publishing. No warranty is expressed or implied, nor will any liability be accepted by Vinidex for any consequences resulting directly or indirectly from the use of such information. Product data and advisory information are subject to change at any time without notice.

VIN297 20110926

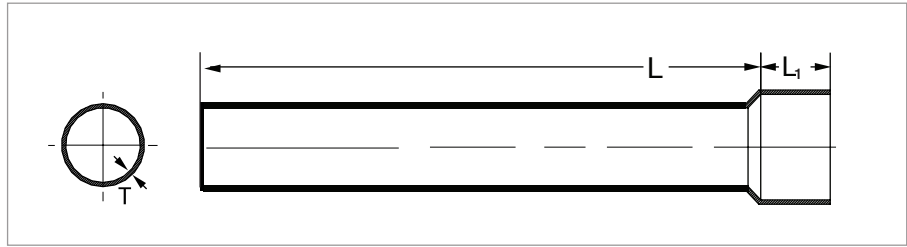
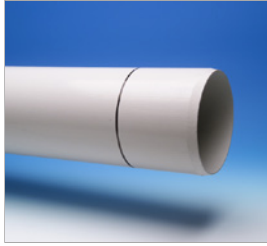

DWV PIPE SCJ

VINIDEX CODE	NOMINAL DIAMETER DN (mm)	REVISED CLASS	LENGTH L (m)	MIN WALL THICKNESS T (mm)	SOCKET DEPTH L' (mm)	PACK QTY	CRATE QTY	WEIGHT (kg)
*								
20200	32	-	6	1.9	-	10	465	1.95
20230	40	-	6	2	-	50	451	2.45
20260	50	-	6	2.2	-	50	260	3.53
20280	65	-	6	2.7	-	20	160	5.34
20310	80	-	6	2.9	-	10	122	6.90
19000	100	SN 6	6	3	55	1	70	9.52
19070	150	SN 4	6	4	80	1	26	18.10
19140	225	SN 4	6	6.5	125	1	12	42.69
19210	300	SN 4	6	7.25	175	1	6	70.90
19180	225	SN 8	6	7.2	125	1	12	55.10
19200	225	SN 8	3	7.2	125	1	12	28.10
19250	300	SN 8	6	9.2	175	1	6	88.22
19258	300	SN 8	3	9.2	175	1	6	45.40

* Unavailable in VIC, WA and SA.

DWV FOAM CORE SCJ PIPE

VINIDEX CODE	NOMINAL DIAMETER DN (mm)	REVISED CLASS	LENGTH L (m)	MIN WALL THICKNESS T (mm)	SOCKET DEPTH L' (mm)	PACK QTY	CRATE QTY	WEIGHT (kg)
18000	100	SN6	6	2.85	55	1	70	7.80
18120	150	SN8	3	5.3	80	1	28	9.00
18110	150	SN8	6	5.3	80	1	28	16.08

NOTE: SN = Stiffness, a measure of ability for the pipe to withstand lateral deflection, "Squashing"

SN4 = 4000 N|m|m
SN8 = 8000 N|m|m

SN6 = 6000 N|m|m
SN10 = 10000 N|m|m

DWV Sewer Fittings SCJ

DWV - Solvent Cement Joint



5° DWV BENDS F & F

VINIDEX CODE	NOMINAL SIZE (mm)	L (mm)	A (mm)	PACK QTY	W (kg)
46000	100	50	57	40	0.24

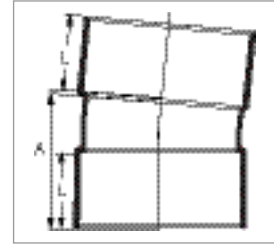

15° DWV BENDS F & F

VINIDEX CODE	NOMINAL SIZE (mm)	L (mm)	A (mm)	PACK QTY	W (kg)
54020	40	27	-	5	0.03
54050	50	30	35	10	0.05
54080	65	38	43.7	5	0.09
46010	100	50	67	40	0.20
47000	150	76	97	1	0.55

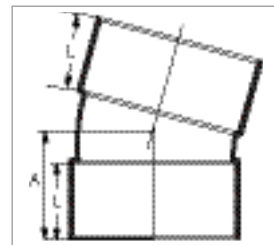

30° DWV BENDS F & F

VINIDEX CODE	NOMINAL SIZE (mm)	L (mm)	A (mm)	PACK QTY	W (kg)
46020	100	50	60.8	34	0.21

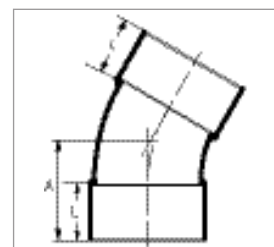

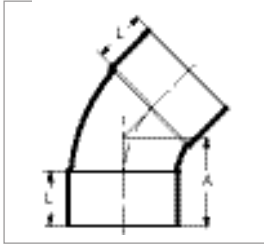

45° DWV BENDS F & F

VINIDEX CODE	NOMINAL SIZE (mm)	L (mm)	A (mm)	PACK QTY	W (kg)
54030	40	27	44.1	20	0.05
54060	50	30	55	10	0.09
	65	38	65	10	0.11
	80	44	64.4	25	0.16
	100	50	72	28	0.26
	150	76	136.1	8	0.92
	225	110	200	1	2.35

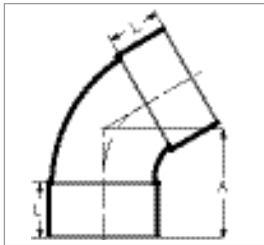

60° DWV BENDS F & F

VINIDEX CODE	NOMINAL SIZE (mm)	L (mm)	A (mm)	PACK QTY	W (kg)
46070	100	50	90	20	0.40

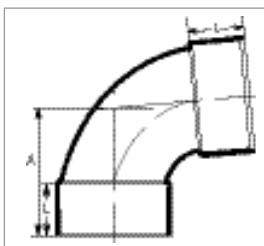

85° DWV BENDS F & F

VINIDEX CODE	NOMINAL SIZE (mm)	L (mm)	A (mm)	PACK QTY	W (kg)
54040	40	27	54.4	20	0.06
54070	50	30	66	45	0.09

DWV Sewer Fittings SCJ

DWV - Solvent Cement Joint



88° DWV BENDS F & F

VINIDEX CODE	NOMINAL SIZE (mm)	L (mm)	A (mm)	PACK QTY	W (kg)
54100	65	38	82	10	0.13
54140	80	44	98.1	10	0.24
46080	100	50	143	20	0.41
47030	150	76	199.2	6	1.14

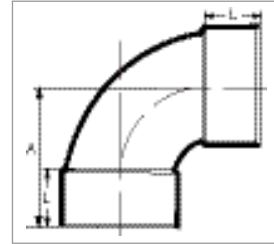

90° DWV BENDS F & F

VINIDEX CODE	NOMINAL SIZE (mm)	L (mm)	A (mm)	PACK QTY	W (kg)
47420	225	110	295	1	3.03

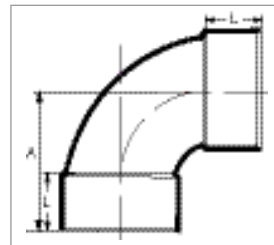

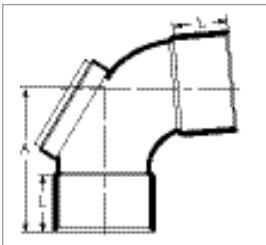
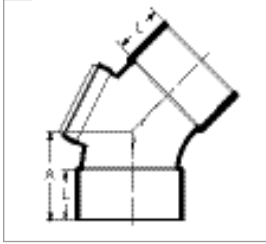

45° DWV I.O. BENDS F & F

VINIDEX CODE	NOMINAL SIZE (mm)	L (mm)	A (mm)	PACK QTY	W (kg)
54310	50	30	53	5	0.12
54340	65	38	65	5	0.11

88° DWV I.O. BENDS F & F

VINIDEX CODE	NOMINAL SIZE (mm)	L (mm)	A (mm)	PACK QTY	W (kg)
54290	40	27	59	20	0.08
54320	50	30	67	10	0.11
54350	65	38	81.4	10	0.19
54410	100	50	155	5	0.66

DWV Sewer Fittings SCJ

DWV - Solvent Cement Joint



45° SIDE ACCESS BEND F & F

VINIDEX CODE	NOMINAL SIZE (mm)	L (mm)	A (mm)	PACK QTY	W (kg)
46050	100	30	116.85	1	0.76

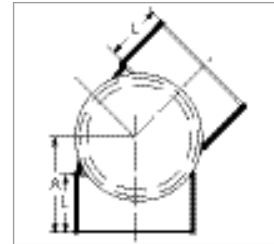

88° SIDE ACCESS BEND F & F

VINIDEX CODE	NOMINAL SIZE (mm)	L (mm)	A (mm)	PACK QTY	W (kg)
46090	100	50	160	1	0.75

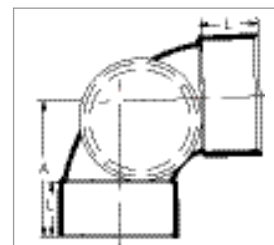



5° DWV PLAIN BENDS M & F

VINIDEX CODE	NOMINAL SIZE (mm)	L (mm)	A (mm)	PACK QTY	W (kg)
46120	100	55	56	1	0.22

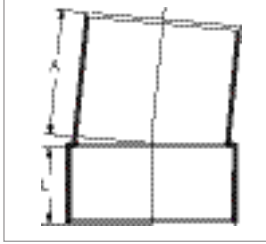

15° DWV PLAIN BENDS M & F

VINIDEX CODE	NOMINAL SIZE (mm)	L (mm)	A (mm)	PACK QTY	W (kg)
46130	100	50	55	1	0.20
47050	150	76	89	1	0.56

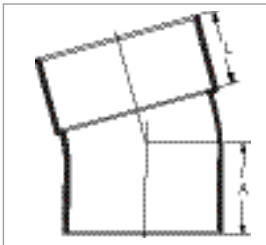

30° DWV PLAIN BENDS M & F

VINIDEX CODE	NOMINAL SIZE (mm)	L (mm)	A (mm)	PACK QTY	W (kg)
46140	100	50	61	5	0.22

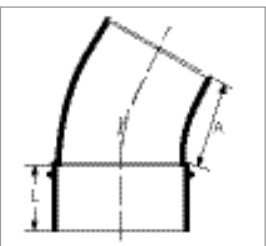

DWV Sewer Fittings SCJ

DWV - Solvent Cement Joint



43° DWV PLAIN BENDS M & F

VINIDEX CODE	NOMINAL SIZE (mm)	L (mm)	A (mm)	PACK QTY	W (kg)
54495	40	27	37.2	10	0.04
54505	50	30	48.3	10	0.06
54530	65	38	59	10	0.10
46150	100	44	64	28	0.29
47060	150	76	126	1	0.99

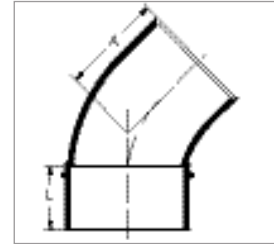

45° DWV PLAIN BENDS M & F

VINIDEX CODE	NOMINAL SIZE (mm)	L (mm)	L' (mm)	A (mm)	PACK QTY	W (kg)
54515	50 x 40	27	37.3	43.5	10	0.05

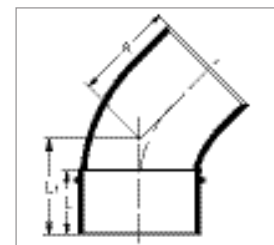

DWV - Solvent Cement Joint

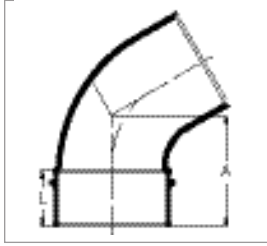

DWV PLAIN BENDS M & F

EX	NOMINAL SIZE (mm)	L (mm)	A (mm)	PACK QTY	W (kg)
0	100	50	90	5	0.38



88° DWV PLAIN BENDS M & F

VINIDEX CODE	NOMINAL SIZE (mm)	L (mm)	L ¹ (mm)	A (mm)	PACK QTY	W (kg)
54542	80	44	98	98	6	0.23
46170	100	50	140	140	5	0.45
47090	150	76	202.2	202.2	1	1.18
54520	50	30	67.4	67.9	10	0.08

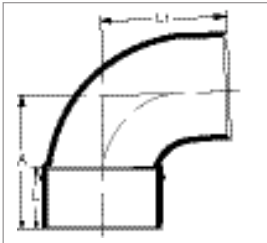

DWV Sewer Fittings SCJ

DWV - Solvent Cement Joint



45° DWV PLAIN JUNCTIONS F & F

VINIDEX CODE	NOMINAL SIZE (mm)	L (mm)	L ¹ (mm)	A (mm)	PACK QTY	W (kg)
54650	50	30	102	150	10	0.15
54670	65	38	125	184	5	0.25
54690	80	44	198	278	1	0.43
46200	100	50	190	259	13	0.60
46205	100	50	190	259	1	0.78
47120	150	76	273	412	4	1.91
47450	225	110	405	576	1	5.20
54760	100 x 50	53	147	228.5	5	0.48
46220	100 x 65	53	166.5	228	5	0.52
47110	150 x 100	76	225.5	328	5	1.39
47440	225	-	286	480	1	3.52
47445	225 x 100	120	255	481	1	3.78
48060	300 x 100	175	398	670	1	9.00
48070	300 x 150	175	468	770	1	0.10

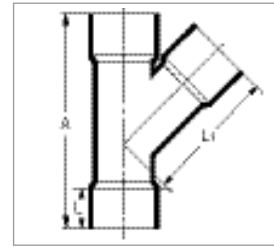

45° DWV PLAIN JUNCTIONS M & F

VINIDEX CODE	NOMINAL SIZE (mm)	L (mm)	L ¹ (mm)	A (mm)	PACK QTY	W (kg)
46250	100	55	190	262	13	0.56
47150	150 x 100	-	328	225.5	1	1.33

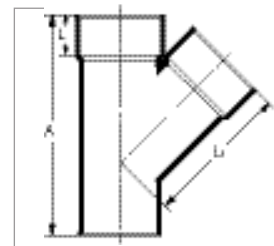

DWV - Solvent Cement Joint



85° DWV PLAIN JUNCTIONS F & F

VINIDEX CODE	NOMINAL SIZE (mm)	L (mm)	L ¹ (mm)	A (mm)	PACK QTY	W (kg)
54660	50	30	80.5	140	10	0.13

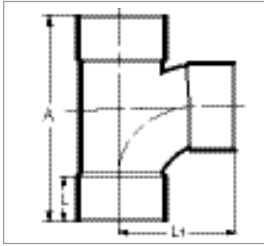

88° DWV PLAIN JUNCTIONS F & F

VINIDEX CODE	NOMINAL SIZE (mm)	L (mm)	L ¹ (mm)	A (mm)	PACK QTY	W (kg)
46300	100	50	145	242	13	0.60
47190	150 x 100	-	175.5	300	1	-
54640	40	27	60.4	190	10	0.07
47205	150	76	204.2	355	4	1.46
47740	225	110	557	770	1	10.00
54680	65	38	-	-	5	0.30

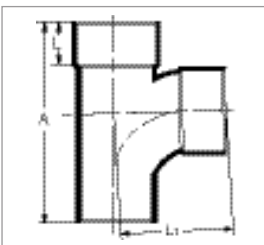
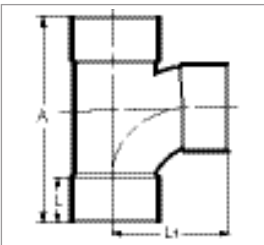

88° DWV PLAIN JUNCTIONS M & F

VINIDEX CODE	NOMINAL SIZE (mm)	L (mm)	L ¹ (mm)	A (mm)	PACK QTY	W (kg)
46320	100	50	145.2	242	13	0.59

DWV Sewer Fittings SCJ

DWV - Solvent Cement Joint



45° DWV I.O. JUNCTIONS F & F

VINIDEX CODE	NOMINAL SIZE (mm)	L (mm)	L ¹ (mm)	A (mm)	PACK QTY	W (kg)
54910	100	50	198	278	6	0.82

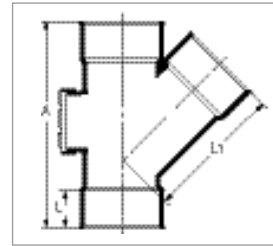

85° DWV I.O. JUNCTIONS F & F

VINIDEX CODE	NOMINAL SIZE (mm)	L (mm)	L ¹ (mm)	A (mm)	PACK QTY	W (kg)
54860	50	30	80.5	140	10	0.16

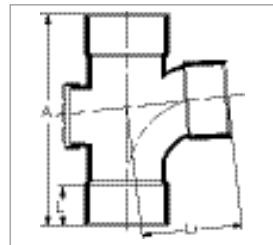

88° DWV I.O. JUNCTIONS F & F

VINIDEX CODE	NOMINAL SIZE (mm)	L (mm)	L ¹ (mm)	A (mm)	PACK QTY	W (kg)
54920	100	50	145.3	240	5	0.71

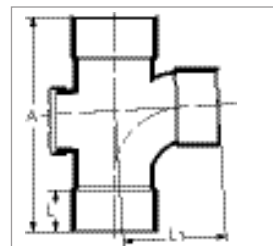

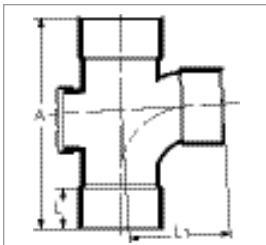
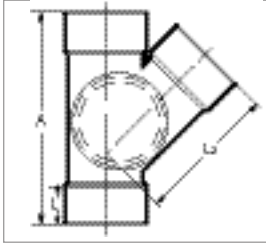

45° SIDE ACCESS JUNCTIONS F & F

VINIDEX CODE	NOMINAL SIZE (mm)	L (mm)	L ¹ (mm)	A (mm)	PACK QTY	W (kg)
46230	100	50	93	277	8	1.00
46240	100	53	93	277	8	1.00

87° REAR ACCESS JUNCTIONS F & F

VINIDEX CODE	NOMINAL SIZE (mm)	L (mm)	L ¹ (mm)	A (mm)	PACK QTY	W (kg)
46310	100	50	145.3	242	10	1.03

DWV Sewer Fittings SCJ

DWV - Solvent Cement Joint



88° RISER JUNCTIONS M & F

VINIDEX CODE	NOMINAL SIZE (mm)	L ¹ (mm)	A (mm)	PACK QTY	W (kg)
55710	80x50x40x40x40	80.3	165.5	5	0.36
55720	80x50x50x40	79	163	5	0.31
46560	100x50	86.6	175	5	0.31
46570	100x50x50x50x40	97.3	210	10	0.59
46575	100x50x50x40x40	78.1	182	10	0.44

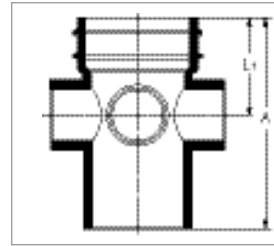

DWV STRAIGHT COUPLINGS F & F

VINIDEX CODE	NOMINAL SIZE (mm)	L (mm)	A (mm)	PACK QTY	W (kg)
55260	40	27	56.5	10	0.03
55270	50	30	65.5	10	0.05
55280	65	38	82	5	0.08
55290	80	44	95	4	0.15
47940	225	110	398	1	0.10
48390	300	175	-	1	0.10

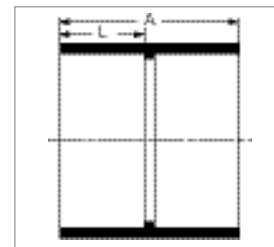
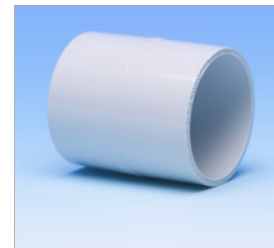

ACCESS COUPLINGS

VINIDEX CODE	NOMINAL SIZE (mm)	L (mm)	A (mm)	PACK QTY	W (kg)
* 46380	100	50	108	40	0.23
* 47240	150	76	158	12	0.66
† 47260	150	76	215	6	1.03

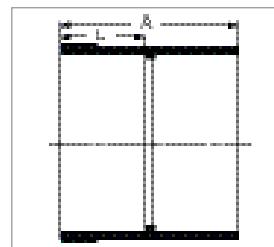
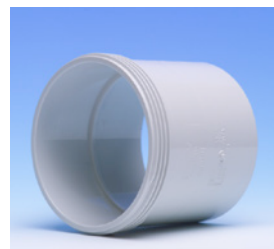

* Without Cap
† RRJ / Spigot

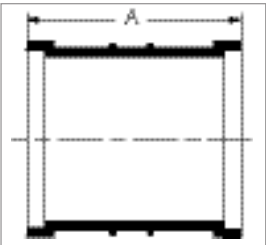
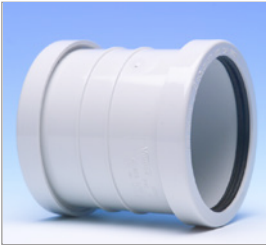
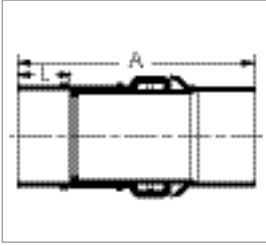

DWV EXPANSION COUPLING ASSEMBLY F & F

VINIDEX CODE	NOMINAL SIZE (mm)	L (mm)	A (mm)	PACK QTY	W (kg)
55750	50	30	78	5	0.14
55760	65	38	97.3	5	0.30
55780	100	50	129.5	3	0.57
55782	100	50	129.5	3	0.34

DWV SLIP COUPLING

VINIDEX CODE	NOMINAL SIZE (mm)	A (mm)	PACK QTY	W (kg)
50220	100	136	5	1.25
50520	150	260	1	1.14
51430	225	340	1	0.10
52150	300	373	1	6.60

DWV Sewer Fittings SCJ

DWV - Solvent Cement Joint



DWV REPAIR COUPLINGS

VINIDEX CODE	NOMINAL SIZE (mm)	L (mm)	A (mm)	PACK QTY	W (kg)
* 58240	100	50	176	4	0.29
58250	100	50	127	1	0.35
58260	150	76	185	1	1.08

* Slab

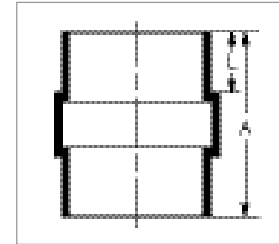

DWV THREADED ACCESS CAPS

VINIDEX CODE	NOMINAL SIZE (mm)	A (mm)	PACK QTY	W (kg)
46430	100	125.3	40	0.16
47270	150	174.7	40	0.32

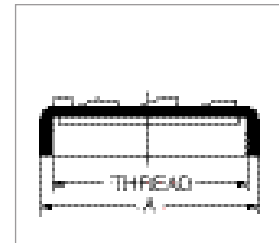

DWV - Solvent Cement Joint

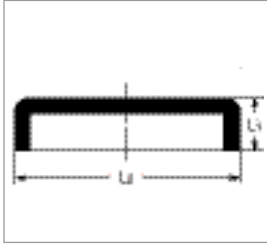
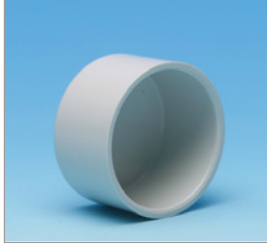

DWV PUSH ON CAPS

VINIDEX CODE	NOMINAL SIZE (mm)	L ¹ (mm)	L ² (mm)	PACK QTY	W (kg)
56000	40	25	47.4	20	0.03
56010	50	25	60.6	20	0.03
56020	65	19	74.1	5	0.03
56030	80	22	88.2	10	0.05
46650	100	28	116.1	26	0.08
47380	150	41.6	165.6	40	0.28
47990	225	150	255.4	1	0.10
48450	300	-	-	1	0.10

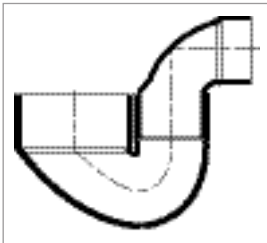

DWV PLAIN FLOOR WASTE GULLIES F & F

VINIDEX CODE	NOMINAL SIZE (mm)	PACK QTY	W (kg)
55460	80 x 50	5	0.48
55470	80 x 65	5	0.52
55485	100 x 50	10	0.38
55486	100 x 65	10	0.40

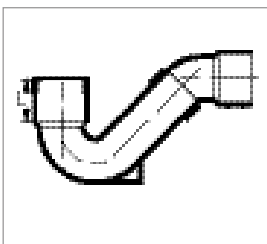

DWV DISCONNECTOR TRAP

VINIDEX CODE	NOMINAL SIZE (mm)	L (mm)	PACK QTY	W (kg)
46520	100	50	10	0.77

DWV Sewer Fittings SCJ

DWV - Solvent Cement Joint



DWV LEVEL INVERT TAPERS M & F

VINIDEX CODE	NOMINAL SIZE (mm)	L (mm)	A (mm)	PACK QTY	W (kg)
55530	50 x 40	27	80	20	0.05
55540	65 x 40	27	100	10	0.08
55550	65 x 50	30	90	20	0.08
55570	80 x 50	33	108	6	0.11
55590	100 x 50	30	150	1	0.21
55600	100 x 65	38	145	5	0.22
55610	100 x 80	44	140	4	0.23
47340	150 x 100	50	233	10	0.70
47910	225 x 150	80	470	1	2.60

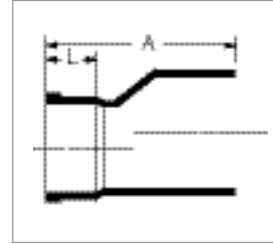
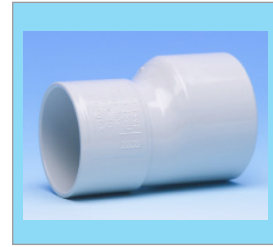

DWV - Solvent Cement Joint

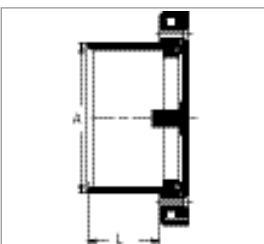
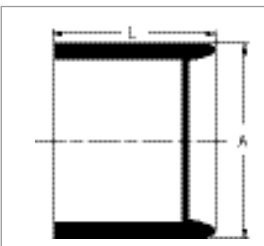
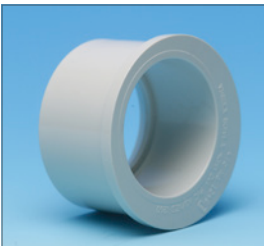
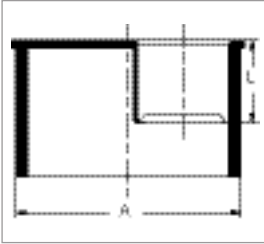

DWV PIPE REDUCERS M & F

VINIDEX CODE	NOMINAL SIZE (mm)	L (mm)	A (mm)	PACK QTY	W (kg)
56120	100 x 40	27	56.5	10	0.14
56130	100 x 50	30	56.5	10	0.14

DWV SOCKET REDUCERS M & F

VINIDEX CODE	NOMINAL SIZE (mm)	L (mm)	A (mm)	PACK QTY	W (kg)
56170	50 x 40	34.5	61.4	10	0.05
56180	65 x 40	38	68.7	10	0.06
56190	65 x 50	42	74.8	5	0.07
56200	80 x 50	45.7	89	5	0.11
56230	100 x 50	52.5	110	10	0.15
56250	100 x 80	52.7	110	5	0.16

DWV BOLTED TRAP SCREWS

VINIDEX CODE	NOMINAL SIZE (mm)	L (mm)	A (mm)	PACK QTY	W (kg)
56080	100	50.8	70.8	5	0.46
56110	150	76	72	5	0.79

DWV Sewer Fittings SCJ

DWV - Solvent Cement Joint



DWV GRATES

VINIDEX CODE		NOMINAL SIZE (mm)	A (mm)	PACK QTY	W (kg)
56270	GRATE	100	140	10	0.09
56280	GRATE & FINISHING COLLAR	100	140	10	0.28
56290	FINISHING COLLAR	100	142.8	10	0.19

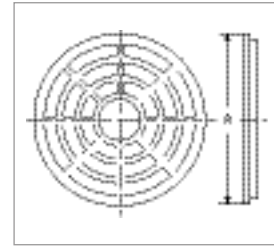

DWV PLAIN VENT COWLS

VINIDEX CODE	NOMINAL SIZE (mm)	L (mm)	A (mm)	PACK QTY	W (kg)
56340	50	33	66	10	0.04
56350	65	38	67.3	5	0.06
56370	100	50	94.3	6	0.20

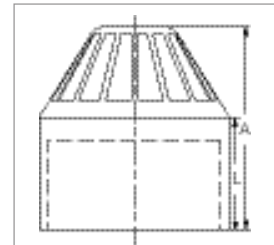

DWV VENT COWLS - INSECT PROOF

VINIDEX CODE	NOMINAL SIZE (mm)	L (mm)	A (mm)	PACK QTY	W (kg)
56440	100	50	94.3	5	0.18

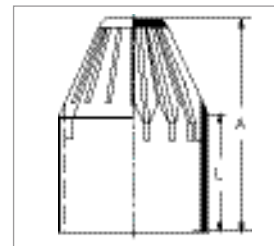

Wire

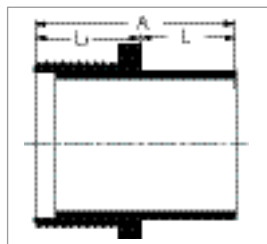
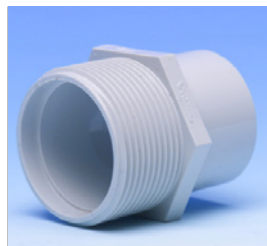
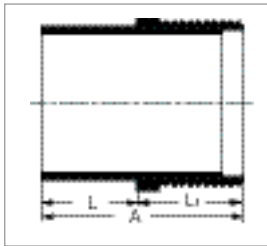
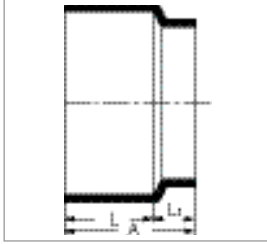
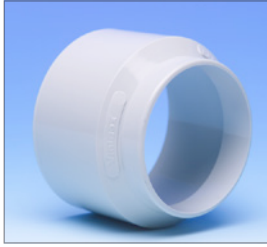

DWV WEATHERING APRONS

VINIDEX CODE	NOMINAL SIZE (mm)	L (mm)	L ¹ (mm)	A (mm)	PACK QTY	W (kg)
56490	65	44	17.5	66.5	5	0.08
56510	100	74.5	21	101.2	5	0.20

DWV IRON CONNECTORS - MALE

VINIDEX CODE	NOMINAL SIZE (mm)	L (mm)	L ¹ (mm)	A (mm)	PACK QTY	W (kg)
56550	40	27	25.4	58.7	10	0.04
56560	50	30	25.4	62	10	0.05

DWV IRON ADAPTORS - MALE

VINIDEX CODE	NOMINAL SIZE (mm)	L (mm)	L ¹ (mm)	A (mm)	PACK QTY	W (kg)
56610	40	27	25.4	59	10	0.04
56620	50	30	25.4	62	10	0.05

DWV Sewer Fittings SCJ

DWV - Solvent Cement Joint



DWV IRON CONNECTORS - FEMALE

VINIDEX CODE	NOMINAL SIZE (mm)	L (mm)	L ¹ (mm)	A (mm)	PACK QTY	W (kg)
56650	40	27	27	52	5	0.04
56660	50	30	27	52	10	0.06

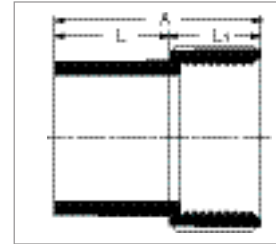

DWV IRON ADAPTORS - FEMALE

VINIDEX CODE	NOMINAL SIZE (mm)	L (mm)	L ¹ (mm)	A (mm)	PACK QTY	W (kg)
56690	40	27	26.8	56	10	0.04
56700	50	30	28.5	60.5	10	0.09

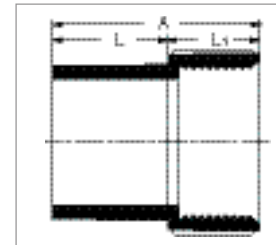
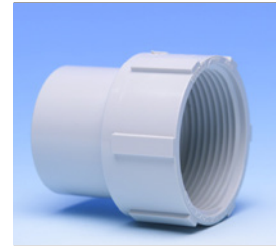

DWV PAN COLLARS M & F

VINIDEX CODE	NOMINAL SIZE (mm)	L (mm)	L ¹ (mm)	A (mm)	PACK QTY	W (kg)
56900	100	50	38	91.2	25	0.25
56905	100	50	58	105	25	0.31
56915	100	50	41	99	1	0.31
56925	100 x 80	44	41	124	5	0.30

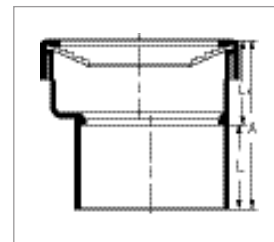
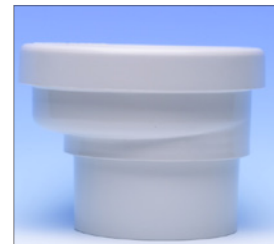



DWV CAPS & LININGS

VINIDEX CODE		NOMINAL SIZE (mm)	L (mm)	L' (mm)	A (mm)	PACK QTY	W (kg)
56950	M & F	40	27	35	64	10	0.04
56970	M & F	50	30	-	-	1	0.07
57000	F & F	50 x 40	32	21	58.5	1	0.07

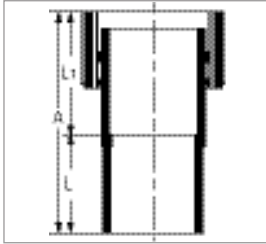

DWV TEST OPENING / INSPECTION TEE / ACCESS FITTING

VINIDEX CODE	NOMINAL SIZE (mm)	L (mm)	A (mm)	PACK QTY	W (kg)
46440	100	50	163	16	0.64
46470	100	50	218.5	18	0.62
57150	100	50	247	7	1.26
47280	150	76	350	4	1.98
47300	150	76	350	4	1.92

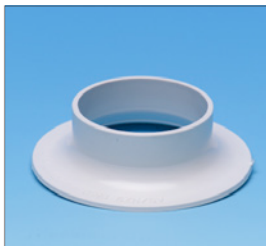
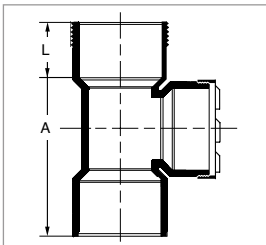

DWV FLOOR FLANGES

VINIDEX CODE	NOMINAL SIZE (mm)	L (mm)	A (mm)	PACK QTY	W (kg)
57160	40	16	75	10	0.01
57170	50	17	100	10	0.03
57190	80	-	145	1	0.08
57200	100	19	160	10	0.07

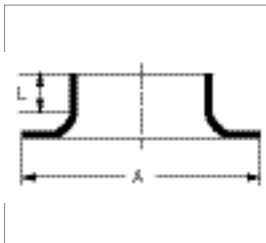

DWV Sewer Fittings SCJ

DWV - Solvent Cement Joint



DWV COPPER TO PVC JOINERS - RRJ

VINIDEX CODE	NOMINAL SIZE (mm)	A (mm)	PACK QTY	W (kg)
57300	40	84.5	5	0.09
57310	50	78.3	5	0.12
57320	65	-	5	0.01
57340	100	75.8	3	0.37

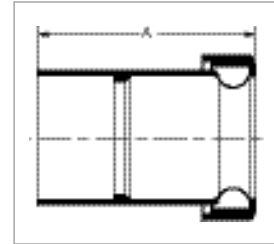

DWV PVC FLAP VALVES

VINIDEX CODE	NOMINAL SIZE (mm)	A (mm)	PACK QTY	W (kg)
57350	50	74	5	0.07
57364	100	-	1	0.50

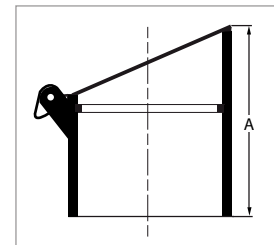

DWV DUST CAPS

VINIDEX CODE	NOMINAL SIZE (mm)	L (mm)	A (mm)	PACK QTY	W (kg)
58220	100	25	113	1	0.022

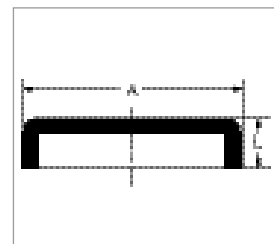

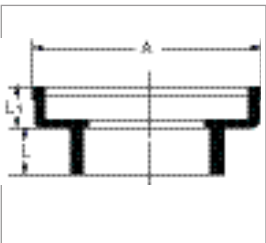
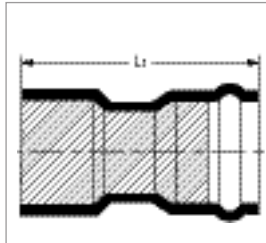
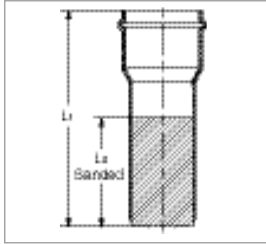

SEWER SANDED MANHOLE COUPLINGS - RRJ

VINIDEX CODE	NOMINAL SIZE (mm)	L ¹ (mm)	L ² (mm)	PACK QTY	W (kg)
50830	100	300	178	1	0.10
50945	150	365	225	1	0.10
51530	225	460	220	1	0.10
52250	300	530	225	1	7.20

COMBINED MANHOLE COUPLINGS - SCJ TO RRJ

VINIDEX CODE	NOMINAL SIZE (mm)	L ¹ (mm)	PACK QTY	W (kg)
50852	100	-	1	0.23
50947	150	-	1	0.10
51535	225	397	1	0.10

PVC - VC SPIGOT ADAPTORS

VINIDEX CODE	NOMINAL SIZE (mm)	L (mm)	L ¹ (mm)	A (mm)	PACK QTY	W (kg)
46630	100	61	50	112	10	0.39
47350	150	67.5	76	150.5	1	0.81
47460	225	110	-	-	1	1.58

DWV Sewer Fittings SCJ

DWV - Solvent Cement Joint



PVC - VC BUSHES

VINIDEX CODE	NOMINAL SIZE (mm)	L (mm)	L' (mm)	PACK QTY	W (kg)
46640	100	50	111	10	0.30
47370	150	70	161	1	0.64

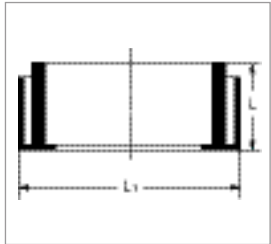

BOSS GULLY

VINIDEX CODE	NOMINAL SIZE (mm)	A (mm)	B (mm)	C (mm)	D (mm)	E (mm)	PACK QTY	W (kg)
70583	100 x 50 x 40 x 40 x 65	111	56	69	219	112	10	0.46

